

# Pressure Switch

Model No. **KCQ-30 Series**

**KINS**



**KCQ-30**

## Summary

This pressure switch is proper for various pressure controlling such as oil pressure, air pressure, water pressure, etc and also flow control, pressure control, liquid level control, etc. It is designed considering shock resistance, durability, etc. Therefore, it is enough proper for ships.

### Safety Management

- Be sure to install a protecting device where exist abrupt change of pressure, vibration and pulsation.
- Do not give impact during the transportation, installation and usage.
- Be sure to avoid places where a lot of steam and poisonous gas exist.

### Purpose of Use

- Various pressure controlling, information system
- Oil pressure press power plant, petrochemistry, etc
- Special fluid line for industrial use, etc.

### Production Specification

- ▶ **Diameter**
  - Square
  - 124mm x 127mm x 90mm (W x H x D)
- ▶ **Accuracy**
  - Repeatability :  $\pm 1.0\%$  of Adj Range
  - Dead Band :  $\pm 4.0\%$
- ▶ **Scale Range**
  - $-0.1 \text{ MPa} \sim 2 \text{ MPa}$ ,  $-0.1 \text{ MPa} \sim 0$ ,  $0 \sim 35 \text{ MPa}$
  - (※  $1 \text{ MPa} = 10.19716 \text{ kgf/cm}^2$ )
- ▶ **Working Pressure**
  - Static pressure : 75% of Full Scale
  - Fluctuating pressure : 60% of Full Scale
- ▶ **Working Temperature**
  - Ambient :  $-20 \sim 65^\circ\text{C}$
  - Fluid :  $-20 \sim 80^\circ\text{C}$

### Product Specification

<b>+ Case</b> <ul style="list-style-type: none"> <li>· Aluminum(Hammer tone coating)</li> </ul>	<b>+ Type</b> <ul style="list-style-type: none"> <li>· Surface Type</li> </ul>	<b>+ Bourdon tube(Element)</b> <ul style="list-style-type: none"> <li>· STS304, STS 316</li> </ul>
<b>+ Case Structure</b> <ul style="list-style-type: none"> <li>· Weather Proof</li> </ul>	<b>+ Contact Form</b> <ul style="list-style-type: none"> <li>· Micro Contact Type</li> <li>· SPDT * 1 (High or Low)</li> <li>(High, Low, High &amp; High High &amp; Low, Low &amp; Low)</li> </ul>	<b>+ Option</b> <ul style="list-style-type: none"> <li>· Throttles</li> <li>· Accessories</li> </ul>
<b>+ Cover</b> <ul style="list-style-type: none"> <li>· Aluminum(Hammer tone coating)</li> </ul>	<b>+ Contact rating</b> <ul style="list-style-type: none"> <li>· AC 125V, 250V 15A</li> <li>· DC 30V 2A / 125V 0.4A / 250V 0.2A</li> </ul>	
<b>+ Connection</b> <ul style="list-style-type: none"> <li>· STS 316</li> <li>· PF, PT, NPT ↔ 1/2, 3/8</li> </ul>		

Pressure Switch

Model No. KCQ-30 Series

Model No. | KCQ-30

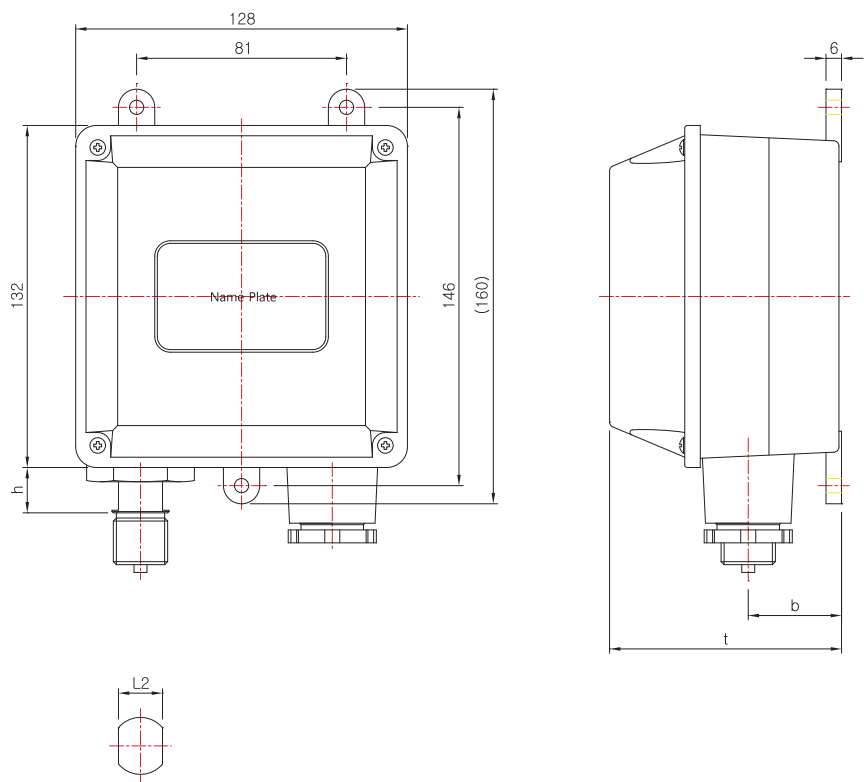

Dimensions (mm)

Model No.	Conn'n (d)	b	t	L2	h
KCQ-30	NPT & PT, PF 3/8	36	(90)	17	(18)
	NPT & PT, PF 1/2				

\*( )The measurement in the blanket is approximate.

Connection diagram

