

# Pressure Gauge (with Electric Contact)

Model No. **SS-3065~6 Series**

**KINS**



**SS-3065 100mm**

## Summary

This gauge has a contact device in the indicator. Not only indicating the pressure but also it is able to control and report by sending an electric message from the built-in contact device where the pressure was set up beforehand

### Safety Management

- Be sure to install a protecting device where exist abrupt change of pressure, vibration and pulsation.
- Do not give impact during the transportation, installation and usage.
- Be sure to install pressure gauge to be horizontal and vertical.

### Purpose of Use

- Various pressure control, information system
- Oil pressure press
- Special fluid line for industrial use, etc.

### Production Specification

- ▶ **Diameter**
  - 100 mm
- ▶ **Accuracy**
  - $\pm 1.0\%$  of Full Scale
- ▶ **Scale Range**
  - $-0.1 \text{ MPa} \sim 0$ ,  $-0.1 \text{ MPa} \sim 2 \text{ MPa}$ ,  $0 \sim 100 \text{ MPa}$
  - (※  $1 \text{ MPa} = 10.19716 \text{ kgf/cm}^2$ )
- ▶ **Working Pressure**
  - Static pressure : 75% of Full Scale
  - Fluctuating pressure : 60% of Full Scale
- ▶ **Working Temperature**
  - Ambient :  $-20 \sim 65 \text{ }^{\circ}\text{C}$
  - Fluid :  $-20 \sim 80 \text{ }^{\circ}\text{C}$

### Product Specification

- |  |  |   |
|--|--|---|
| <ul style="list-style-type: none"> <li>+ <b>Case</b> <ul style="list-style-type: none"> <li>· STS 304</li> </ul> </li> <li>+ <b>Cover</b> <ul style="list-style-type: none"> <li>· STS 304</li> <li>· Slip-on-Fit</li> </ul> </li> <li>+ <b>Connection</b> <ul style="list-style-type: none"> <li>· STS 316</li> <li>· PF, PT, NPT ↔ 1/4, 3/8, 1/2</li> </ul> </li> <li>+ <b>Window</b> <ul style="list-style-type: none"> <li>· Tempered safety glass,</li> <li>Laminated safety glass</li> </ul> </li> <li>+ <b>Type</b> <ul style="list-style-type: none"> <li>· A-Type (Rimless type)</li> <li>· B-Type (Surface type)</li> <li>· D-Type (Flush mounting type)</li> <li>· BD-Type (Panel attachment type)</li> </ul> </li> </ul> | <ul style="list-style-type: none"> <li>+ <b>Pointer</b> <ul style="list-style-type: none"> <li>· Phosphor bronze</li> <li>· Black coating</li> <li>Contact indicator High ↔ red</li> <li>Contact indicator Low ↔ Green</li> </ul> </li> <li>+ <b>Dial</b> <ul style="list-style-type: none"> <li>· Aluminum</li> <li>· White color coating</li> <li>· Black (MPa), red (bar) gradations and characters</li> </ul> </li> <li>+ <b>Contact rating</b> <ul style="list-style-type: none"> <li>· AC 125V 1.0A / 250V 0.7A</li> </ul> </li> <li>+ <b>Element</b> <ul style="list-style-type: none"> <li>· STS 304, STS 316</li> <li>· C type bourdon tube, helical type bourdon tube</li> </ul> </li> </ul> | <ul style="list-style-type: none"> <li>+ <b>Movement</b> <ul style="list-style-type: none"> <li>· STS 304</li> </ul> </li> <li>+ <b>Contact Form</b> <ul style="list-style-type: none"> <li>· SPST * 1, SPST * 2</li> <li>· High, low 2 contact(High or Low, High &amp; High</li> <li>High &amp; Low, Low &amp; Low)</li> </ul> </li> <li>+ <b>Option</b> <ul style="list-style-type: none"> <li>· Bracket</li> <li>· Throttles</li> <li>· Accessories</li> </ul> </li> </ul> |
|--|--|---|

Pressure Gauge (with Electric Contact)

Model No. SS-3065~6 Series

Model No. | SS-3065 (100mm)  
A-Type (Rimless type)

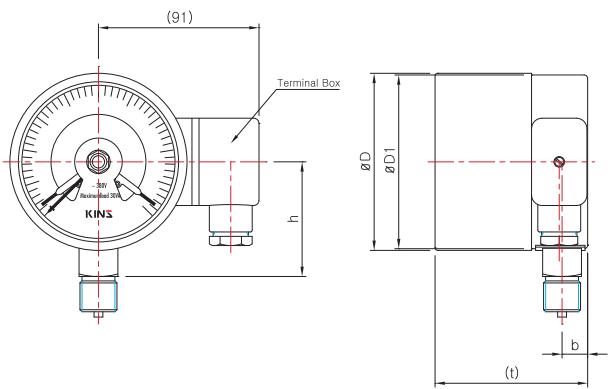

Model No. | SS-3066 (100mm)  
B-Type (Surface type)

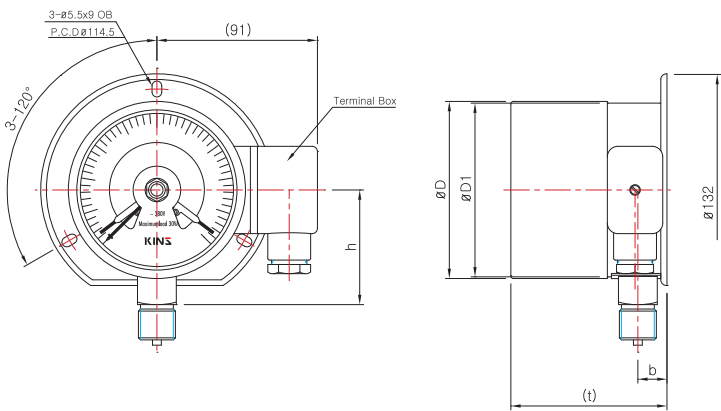

Dimensions (mm)

	Model No.	Conn'n (d)	ØD	ØD1	b	n	t	L2	h
100mm	SS-3065	NPT & PT, PF 1/4	100.5	98.7	15	—	(86.5)	22	(65)
		NPT & PT, PF 3/8							
		NPT & PT, PF 1/2							
	SS-3066	NPT & PT, PF 1/4	114	100	17	—	(88.5)	22	(65)
		NPT & PT, PF 3/8							
		NPT & PT, PF 1/2							

\*( )The measurement in the blanket is approximate.