

# Accessories of Pressure Gauge

## Model No. SS-DP Dampener Series



Dampener

### Summary

Those accessories' performance and lifespan are dependent on selection of the gauge, correct installation and using method. Therefore, before installing a pressure gauge, it is important to select a proper accessory for purpose of use. A Dampener (kind of a needle valve) which is a joint instrument of variable type is attached with a pressure gauge in a place where the pressure pulsation works, and used for the prevention of damage by pulsation. It is used by controlling the indicating valve of the pressure gauge after installing it.

### Purpose of Use

- A place where the pressure pulsation works
- Where oil should not go in.
- Overpressure and removal of bubble
- For air vent plug

### Production Specification

- ▶ Materials
  - Brass
  - Stainless Steel
- ▶ Connection

| Material  | Gauge  | Pipe   |
|-----------|--------|--------|
| BS<br>STS | PF 1/4 | PF 1/4 |
|           | PF 3/8 | PF 3/8 |
|           | PF 1/2 | PF 1/2 |

- ▶ Test Pressure
  - 30 MPa
- ▶ Maximum Working Pressure
  - 20 MPa
- ▶ Maximum Working Temperature
  - 200 °C

### Product Specification

#### + Body

- Brass · · · BSBM
- Steel · · · STS 316

#### + Stopper

- Brass · · · STS 316
- Steel · · · STS 316

#### + Gasket-Outlet

- Brass · · · Teflon
- St, St · · · Teflon

#### + Joint

- Brass · · · SS41 (Ni-plating)
- Steel · · · STS 316

#### + Washer

- Brass · · · BSBM
- St, St · · · STS 316

#### + Retaining screw

- Brass · · · SS41 (Ni-plating)
- St, St · · · SS41 (Ni-plating)

#### + Type

- PF(Male) x PF(Male)
- PF(Male) x PT(Female)
- PT(Female) x PF(Male)
- PT(Female) x PT(Female)

## Model No. | SS-DP01 Dampener (Female x Male)

Dimensions (mm)

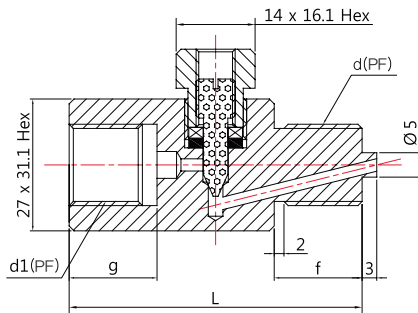

| Model No.          | Con'n(d1) | Con'n(d) | g  | k  | L  |
|--------------------|-----------|----------|----|----|----|
| Dampener (PF x PF) | PF 1/4    | PF 1/4   | 16 | 16 | 56 |
|                    | PF 1/4    | PF 3/8   | 16 | 18 | 58 |
|                    | PF 1/4    | PF 1/2   | 16 | 20 | 60 |
|                    | PF 3/8    | PF 1/4   | 18 | 16 | 58 |
|                    | PF 3/8    | PF 3/8   | 18 | 18 | 60 |
|                    | PF 3/8    | PF 1/2   | 18 | 20 | 62 |
|                    | PF 1/2    | PF 1/4   | 20 | 16 | 60 |
|                    | PF 1/2    | PF 3/8   | 20 | 18 | 62 |
|                    | PF 1/2    | PF 1/2   | 20 | 20 | 64 |

## Model No. | SS-DP02 Dampener (Female x Male)

Dimensions (mm)

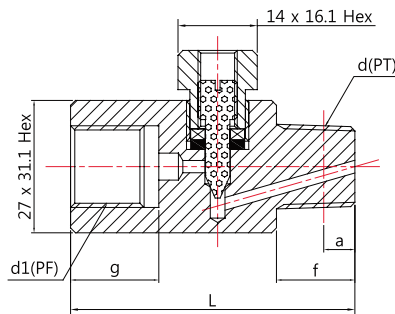

| Model No.          | Con'n(d1) | Con'n(d) | g  | k  | L  |
|--------------------|-----------|----------|----|----|----|
| Dampener (PF x PT) | PF 1/4    | PT 1/4   | 16 | 16 | 54 |
|                    | PF 1/4    | PT 3/8   | 16 | 18 | 56 |
|                    | PF 1/4    | PT 1/2   | 16 | 20 | 58 |
|                    | PF 3/8    | PT 1/4   | 18 | 16 | 56 |
|                    | PF 3/8    | PT 3/8   | 18 | 18 | 58 |
|                    | PF 3/8    | PT 1/2   | 18 | 20 | 60 |
|                    | PF 1/2    | PT 1/4   | 20 | 16 | 58 |
|                    | PF 1/2    | PT 3/8   | 20 | 18 | 60 |
|                    | PF 1/2    | PT 1/2   | 20 | 20 | 62 |

## Model No. | SS-DP03 Dampener (Female x Male)

Dimensions (mm)

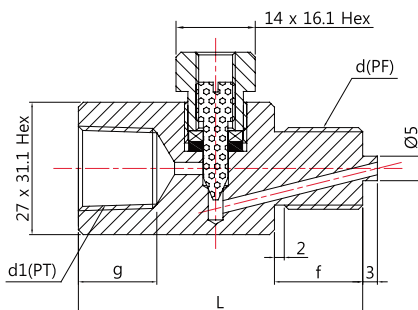

| Model No.          | Con'n(d1) | Con'n(d) | g  | k  | L  |
|--------------------|-----------|----------|----|----|----|
| Dampener (PT x PF) | PT 1/4    | PF 1/4   | 14 | 16 | 54 |
|                    | PT 1/4    | PF 3/8   | 14 | 18 | 56 |
|                    | PT 1/4    | PF 1/2   | 14 | 20 | 58 |
|                    | PT 3/8    | PF 1/4   | 16 | 16 | 56 |
|                    | PT 3/8    | PF 3/8   | 16 | 18 | 58 |
|                    | PT 3/8    | PF 1/2   | 16 | 20 | 60 |
|                    | PT 1/2    | PF 1/4   | 18 | 16 | 58 |
|                    | PT 1/2    | PF 3/8   | 18 | 18 | 60 |
|                    | PT 1/2    | PF 1/2   | 18 | 20 | 62 |

## Model No. | SS-DP04 Dampener (Female x Male)

Dimensions (mm)

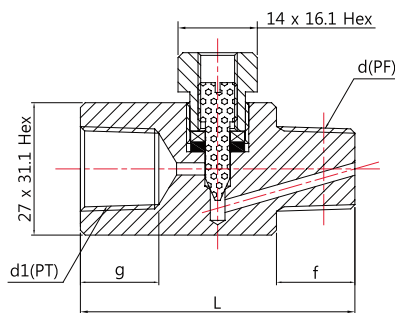

| Model No.          | Con'n(d1) | Con'n(d) | g  | k  | L  |
|--------------------|-----------|----------|----|----|----|
| Dampener (PT x PT) | PT 1/4    | PT 1/4   | 14 | 14 | 56 |
|                    | PT 1/4    | PT 3/8   | 14 | 16 | 58 |
|                    | PT 1/4    | PT 1/2   | 14 | 18 | 60 |
|                    | PT 3/8    | PT 1/4   | 16 | 14 | 58 |
|                    | PT 3/8    | PT 3/8   | 16 | 16 | 60 |
|                    | PT 3/8    | PT 1/2   | 16 | 18 | 62 |
|                    | PT 1/2    | PT 1/4   | 18 | 14 | 60 |
|                    | PT 1/2    | PT 3/8   | 18 | 16 | 62 |
|                    | PT 1/2    | PT 1/2   | 18 | 18 | 64 |