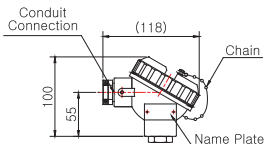
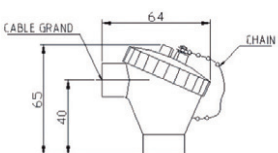
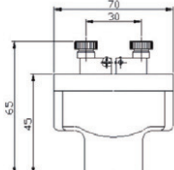
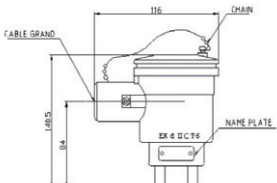
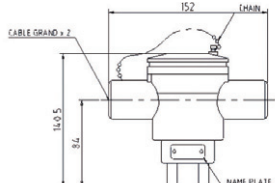
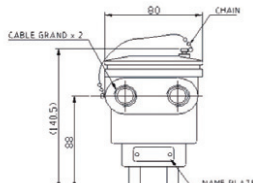
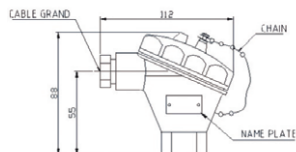
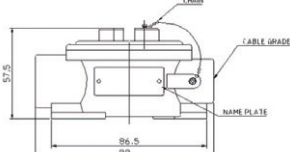
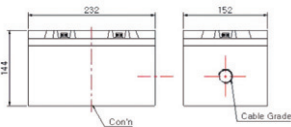

Thermocouple

Model No. **SS-5010 Series**

Terminal Boxes

Type	Weather Proof W	General Purpose S	Exposed Terminal L
Material : Conduit Conn : No. of Terminals : Terminal Block : Surface Finish : Surface Color :	Al-alloy diecast, Cast Iron PF1/2 . PF3/4 2, 3, 4, 6 Bakelite . Ceramic Melamin baked Metallic silver	Al-alloy diecast, Phenol Resin PF3/8 2, 3 Bakelite . Ceramic Melamin baked Metallic silver	Al-ally diecast — 2 Bakelite . Ceramic Melamin baked Metallic silver
Dimensions	PF 1/2 (W/Cable Gland), PF3/4 	PF 1/4 	PF1/2 
Type	Flame Proof E (EX d II C T6)	Two Way Entry	Two Entry
Material : Conduit Conn : No. of Terminals : Terminal Block : Surface Finish : Surface Color :	Al-alloy diecast, Cast Iron Stainless steel PF1/2 . PF3/4 2, 3, 4, 6 Bakelite . Ceramic Melamin baked Metallic silver	Al-alloy diecast, Phenol Resin Stainless steel PF1/2x2 4, 6 Bakelite . Ceramic Melamin baked Metallic silver	Al-alloy diecast, Phenol Resin Stainless steel PF1/2x2 4, 6 Bakelite . Ceramic Melamin baked Metallic silver
Dimensions	PF 1/2" 	PF 1/2" 	PF 1/2" 
Type	Weather Proof SW	D uctType	Multy Type (EX d II B T5)
Material : Conduit Conn : No. of Terminals : Terminal Block : Surface Finish : Surface Color :	Al-alloy diecast, 316SS PF1/2 . PF3/4 2, 3, 4, 6 Bakelite . Ceramic Grinding Metallic silver	Al-alloy diecast, 316SS PF1/2 . PF3/4 2, 3, 4, 6 Bakelite . Ceramic Melamin baked Metallic silver	Al-alloy diecast PF3/4 10, 20 Bakelite . Ceramic Pulverulent-Coating Hammer-Tone
Dimensions	PF 1/2" 	PF 1/2" 	PF 1/2" 

Weather Proof Head Type

Model No. | SS-5011W
(Metal Protection Tube)

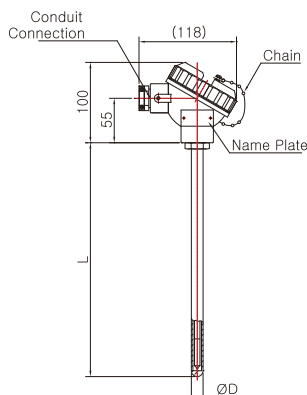

Model No. | SS-5011W-1
(Ceramic Protection Tube)

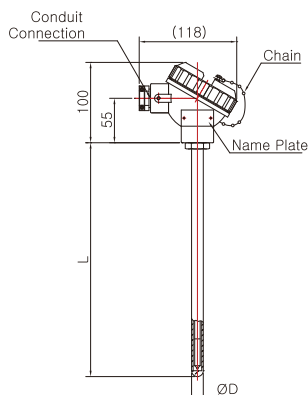

Model No. | SS-5011W-2
(Ceramic Protection Tube)

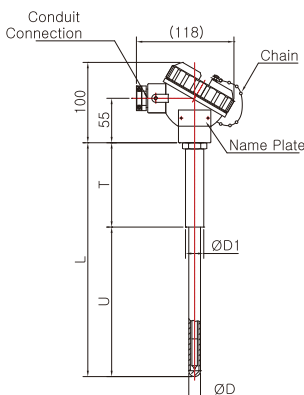

Model No. | SS-5011W-3
(Dual Ceramic Protection Tube)

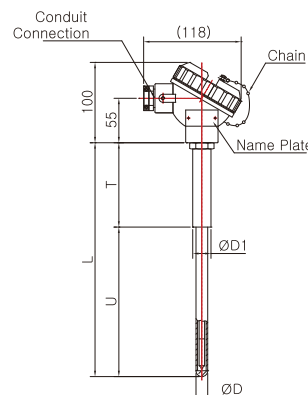

Model No. | SS-5011W-4
(Metal Protection Tube)

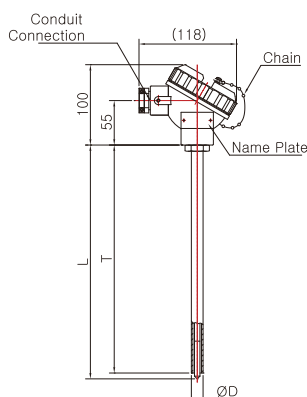

Model No. | SS-5012W
(Metal Protection Tube)

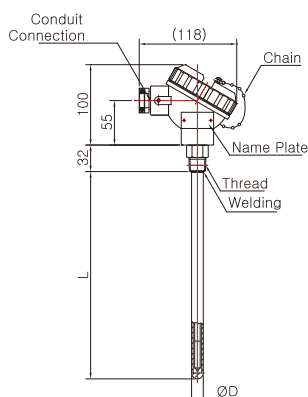

Model No. | SS-5012W-1
(Metal Protection Tube)

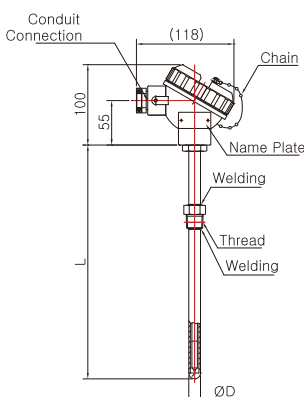

Model No. | SS-5012W-2
(Metal Protection Tube)

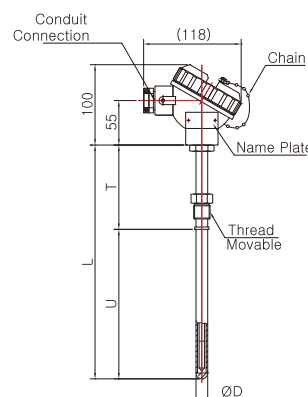

Model No. | SS-5012W-3
(Metal Protection Tube)

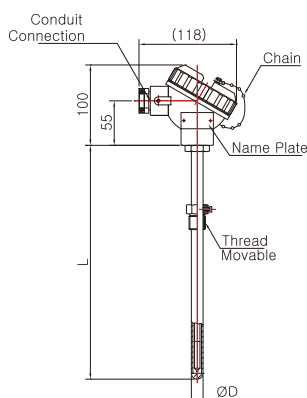

Model No. | SS-5012W-4
(Metal Protection Tube)

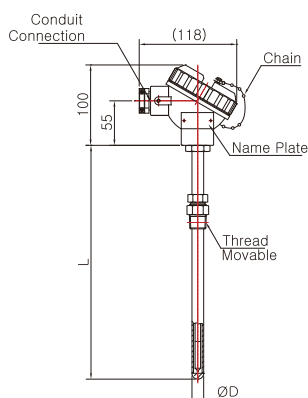

Model No. | SS-5013W
(Metal Protection Tube)

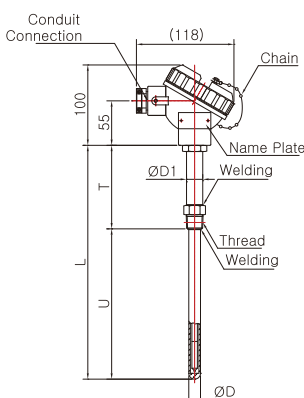

Model No. | SS-5013W
(Ceramic Protection Tube)

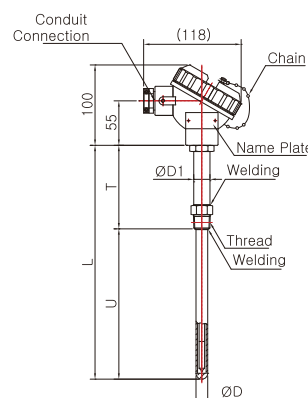

Thermocouple

Model No. SS-5010 Series

Weather Proof Head Type

Model No. | SS-5014W
(Ceramic Protection Tube)

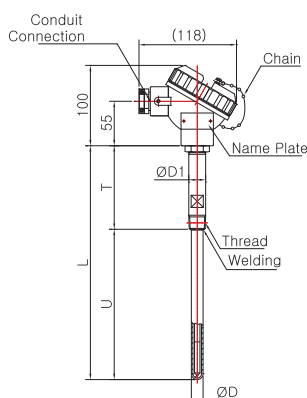

Model No. | SS-5014W-1
(Metal Protection Tube)

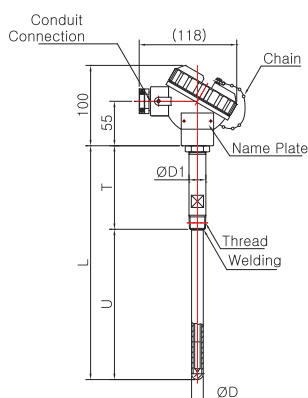

Model No. | SS-5014W-1-1
(Metal Protection Tube)

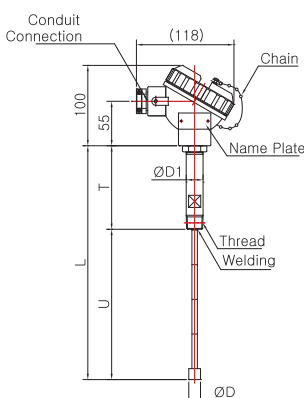

Model No. | SS-5014W-2
(Metal Protection Tube)

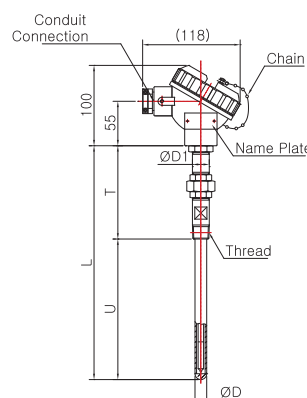

Model No. | SS-5014W-2-1
(Metal Protection Tube)

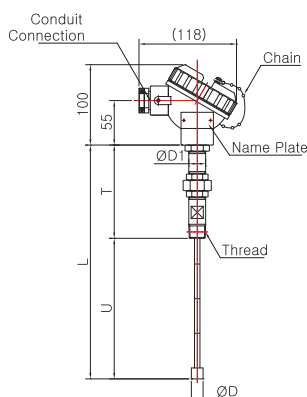

Model No. | SS-5014W-3
(Metal Protection Tube)

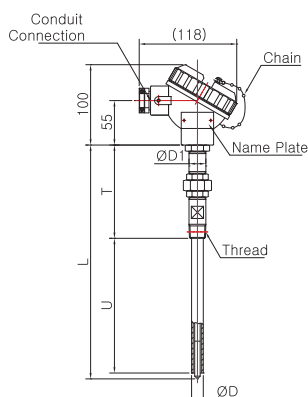

Model No. | SS-5015W
(Metal Protection Tube)

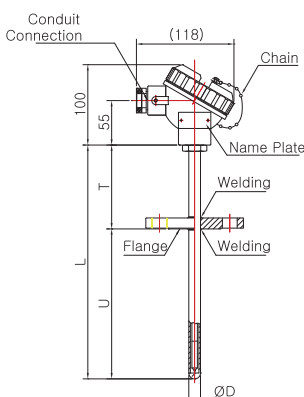

Model No. | SS-5015W-1
(Metal Protection Tube)

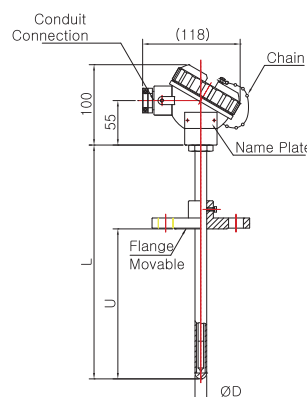

Model No. | SS-5016W
(Metal Protection Tube)

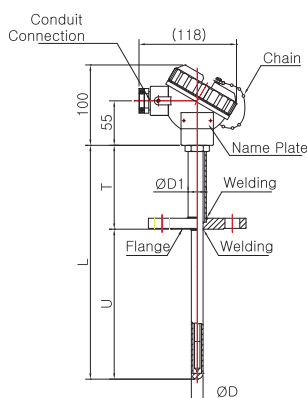

Model No. | SS-5016W-1
(Ceramic Protection Tube)

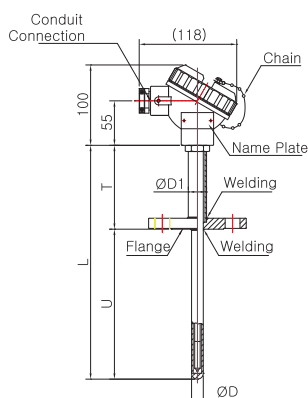

Model No. | SS-5016W-2
(Metal Protection Tube)

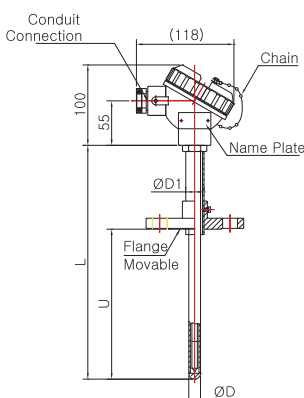

Model No. | SS-5016W-3
(Metal Protection Tube)

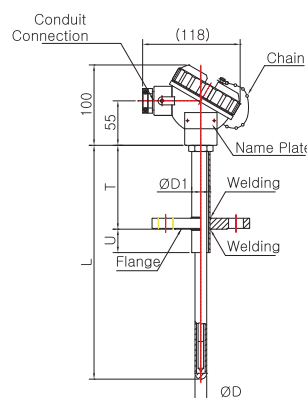

Weather Proof Head Type

Model No. | SS-5017W
(Metal Protection Tube)

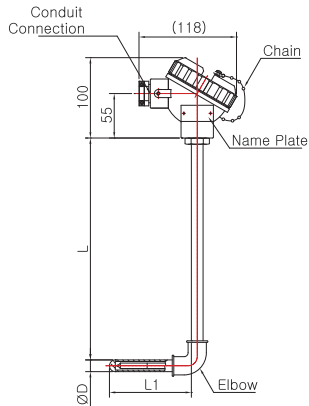

Model No. | SS-5019W
(Metal Protection Tube)

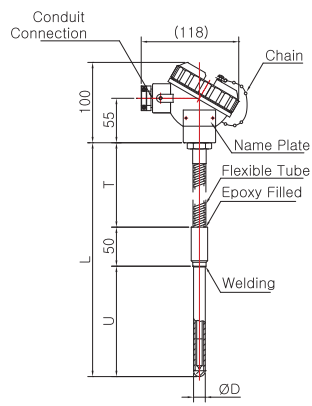

Model No. | SS-5019W-1
(Metal Protection Tube)

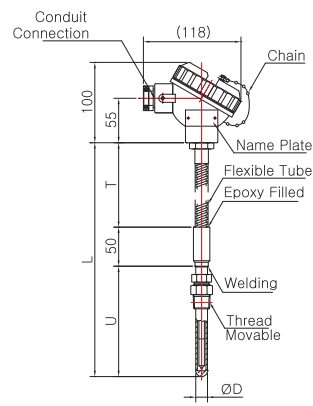

Model No. | SS-5019W-2
(Metal Protection Tube)

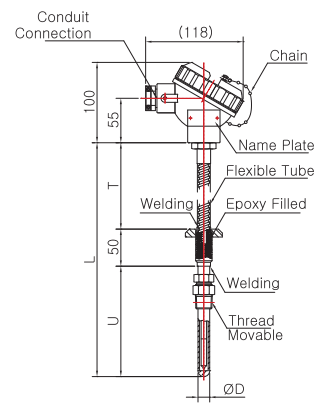

Pressure Gauge

Differential Pressure Gauge & Switch

Accessories of Pressure Gauge

Thermometer & Thermometer Switch

Thermocouple & R.T.D

Thermowell

Transmitter

Indicator etc.

Technical data

Thermocouple

Model No. SS-5010 Series

Explosion Proof Head Type (Ex d IIC T6)

Model No. | SS-5011E
(Metal Protection Tube)

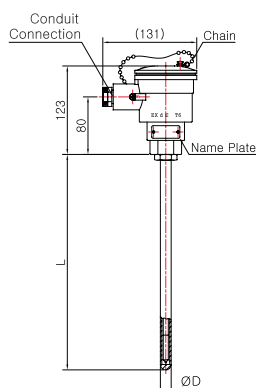

Model No. | SS-5011E-1
(Ceramic Protection Tube)

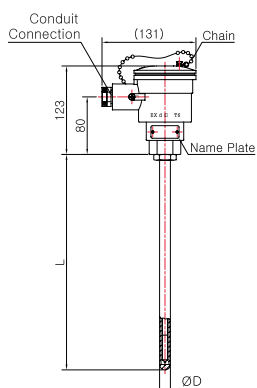

Model No. | SS-5011E-2
(Ceramic Protection Tube)

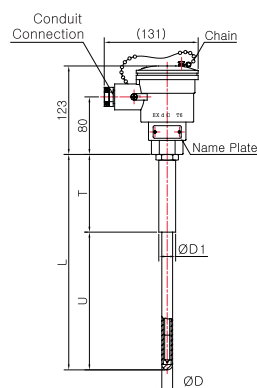

Model No. | SS-5011E-3
(Dual Ceramic Protection Tube)

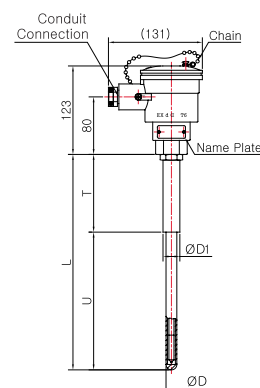

Model No. | SS-5011E-4
(Metal Protection Tube)

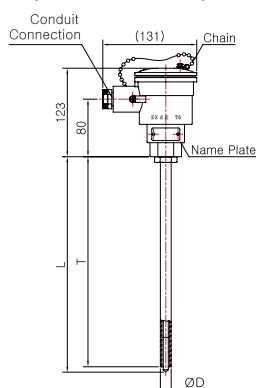

Model No. | SS-5012E
(Metal Protection Tube)

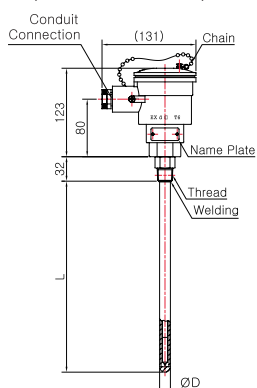

Model No. | SS-5012E-1
(Metal Protection Tube)

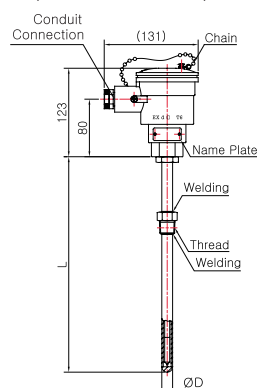

Model No. | SS-5012E-2
(Metal Protection Tube)

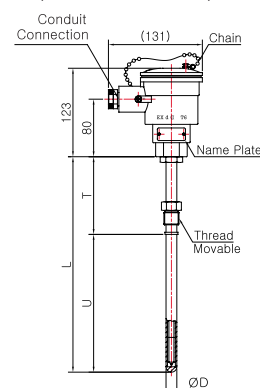

Model No. | SS-5012E-3
(Metal Protection Tube)

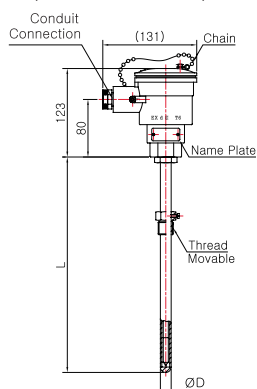

Model No. | SS-5012E-4
(Metal Protection Tube)

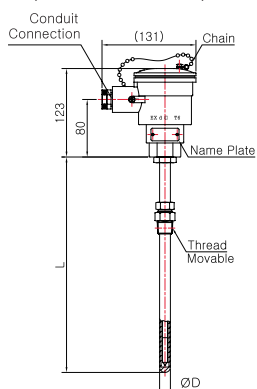

Model No. | SS-5013E
(Metal Protection Tube)

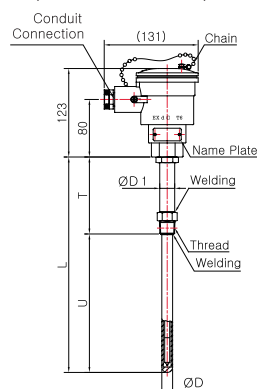

Model No. | SS-5013E-1
(Ceramic Protection Tube)

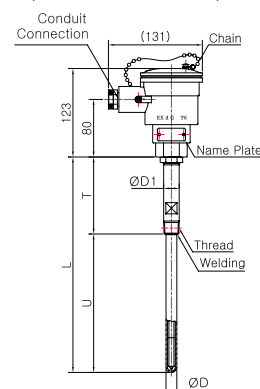

Explosion Proof Head Type (Ex d IIC T6)

Model No. | SS-5014E
(Ceramic Protection Tube)

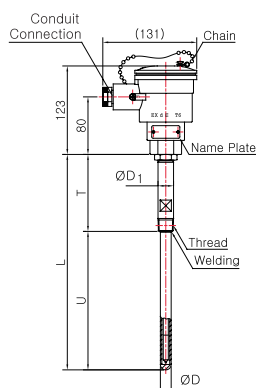

Model No. | SS-5014E-1
(Metal Protection Tube)

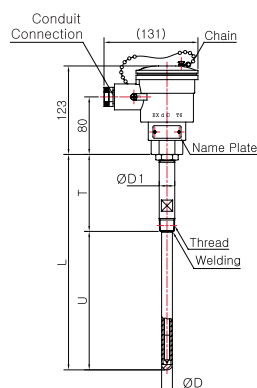

Model No. | SS-5014E-1-1
(Metal Protection Tube)

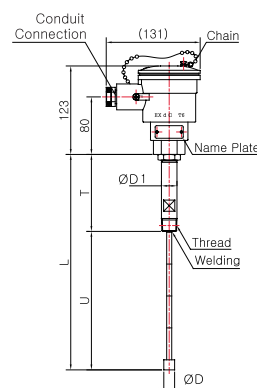

Model No. | SS-5014E-2
(Metal Protection Tube)

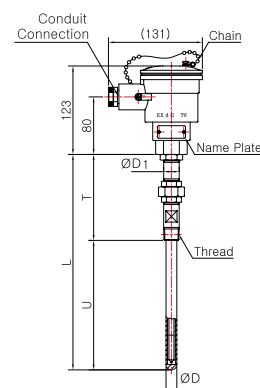

Model No. | SS-5014E-2-1
(Metal Protection Tube)

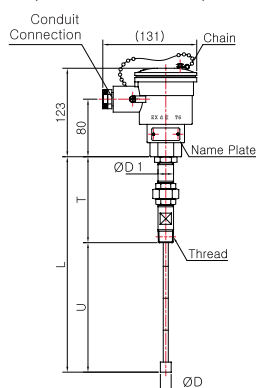

Model No. | SS-5014E-3
(Metal Protection Tube)

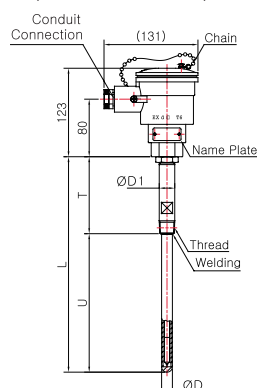

Model No. | SS-5015E
(Metal Protection Tube)

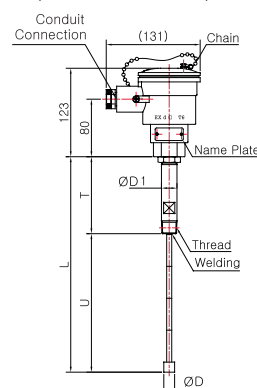

Model No. | SS-5013E-1
(Metal Protection Tube)

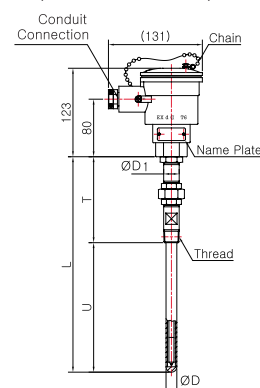

Model No. | SS-5016E
(Metal Protection Tube)

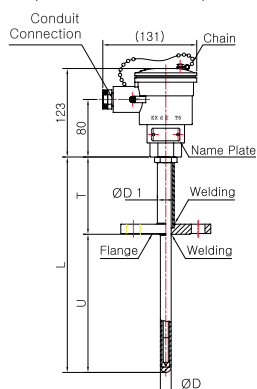

Model No. | SS-5016E-1
(Ceramic Protection Tube)

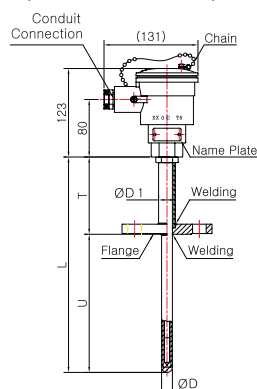

Model No. | SS-5016E-1
(Metal Protection Tube)

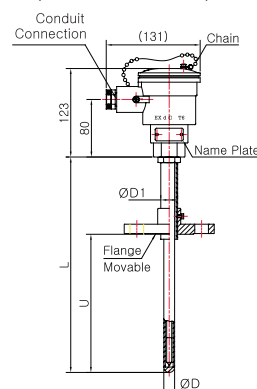

Model No. | SS-5016E-3
(Metal Protection Tube)

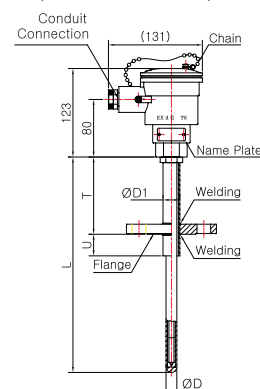

Thermocouple

Model No. SS-5010 Series

Explosion Proof Head Type (Ex d IIC T6)

Model No. | SS-5017E
(Metal Protection Tube)

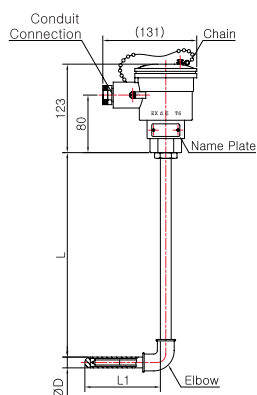

Model No. | SS-5019E
(Metal Protection Tube)

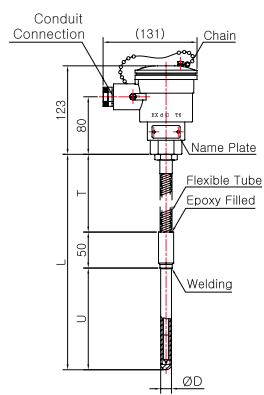

Model No. | SS-5019E-1
(Metal Protection Tube)

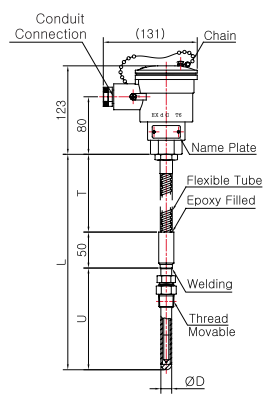

Model No. | SS-5019E-2
(Metal Protection Tube)

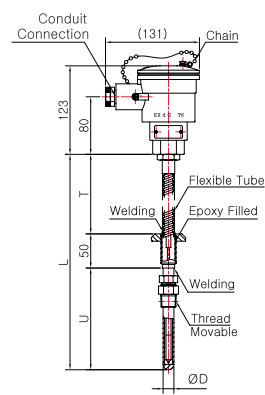

General Purpose Head Type

Model No. | SS-5011S
(Ceramic Protection Tube)

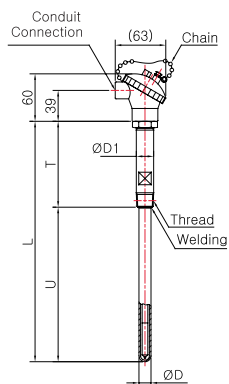

Model No. | SS-5011S-1
(Ceramic Protection Tube)

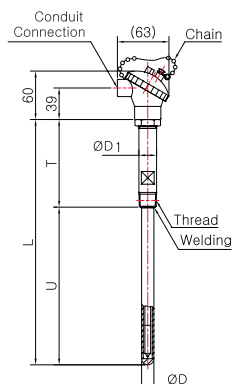

Model No. | SS-5011S-2
(Ceramic Protection Tube)

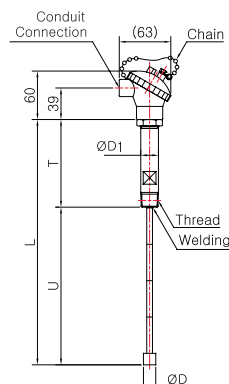

Model No. | SS-5011S-3
(Ceramic Protection Tube)

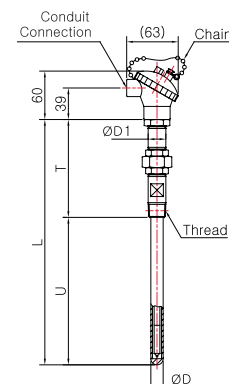

Model No. | SS-5011S-4
(Metal Protection Tube)

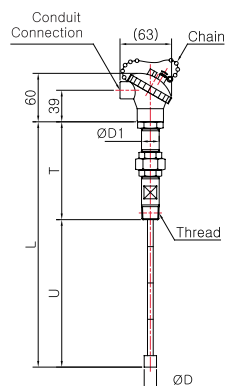

Model No. | SS-5012S
(Metal Protection Tube)

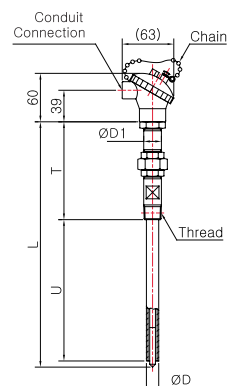

Model No. | SS-5012S-1
(Metal Protection Tube)

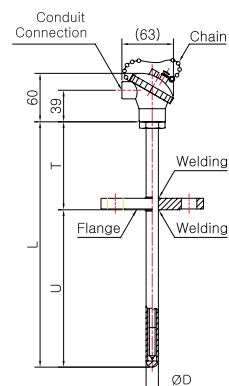

Model No. | SS-5012S-2
(Metal Protection Tube)

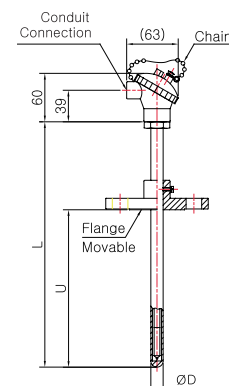

Model No. | SS-5012S-3
(Metal Protection Tube)

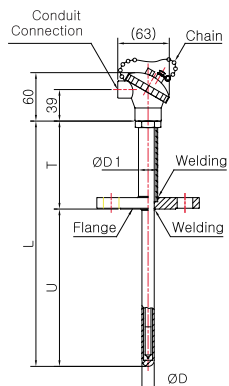

Model No. | SS-5012S-4
(Metal Protection Tube)

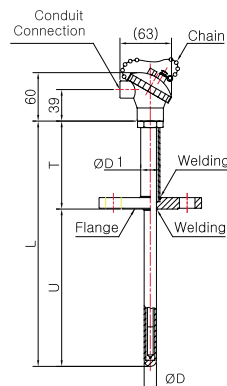

Model No. | SS-5013S
(Metal Protection Tube)

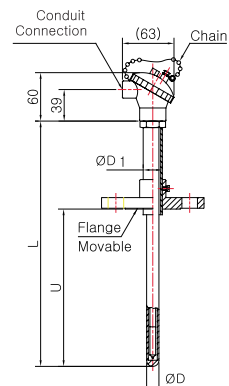

Model No. | SS-5013S-1
(Ceramic Protection Tube)

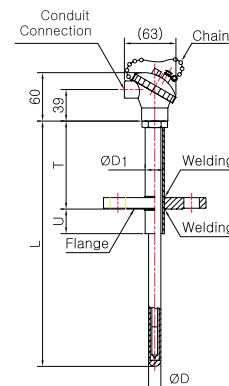

Thermocouple

Model No. SS-5010 Series

General Purpose Head Type

Model No. | SS-5014S
(Ceramic Protection Tube)

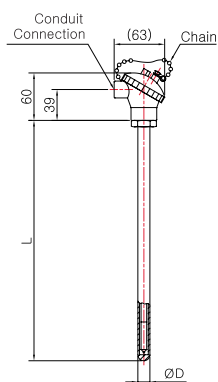

Model No. | SS-5014S-1
(Metal Protection Tube)

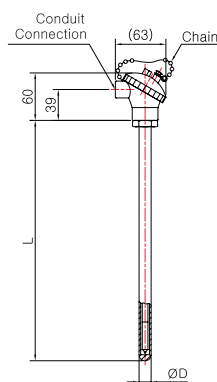

Model No. | SS-5014S-1-1
(Metal Protection Tube)

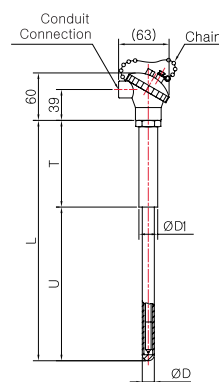

Model No. | SS-5014S-2
(Metal Protection Tube)

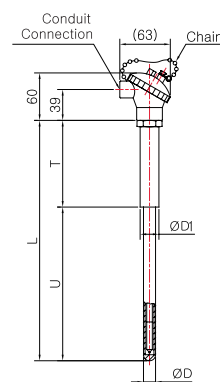

Model No. | SS-5014S-2-1
(Metal Protection Tube)

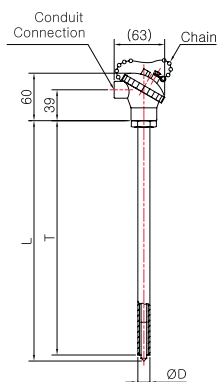

Model No. | SS-5014S-3
(Metal Protection Tube)

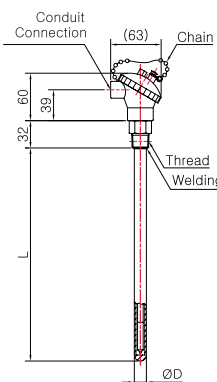

Model No. | SS-5015S
(Metal Protection Tube)

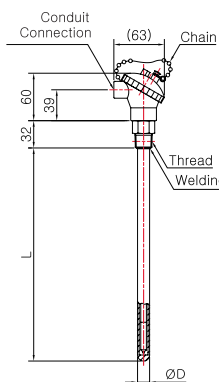

Model No. | SS-5015S-1
(Metal Protection Tube)

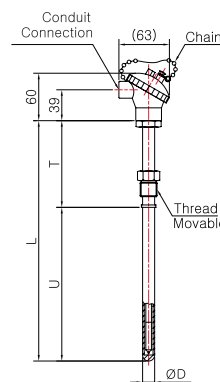

Model No. | SS-5016S
(Metal Protection Tube)

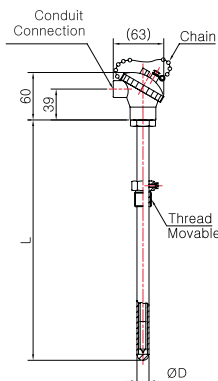

Model No. | SS-5016S-1
(Ceramic Protection Tube)

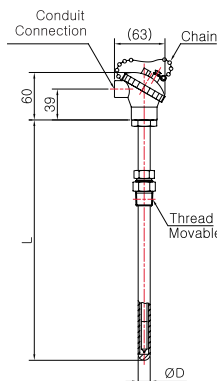

Model No. | SS-5016S-2
(Metal Protection Tube)

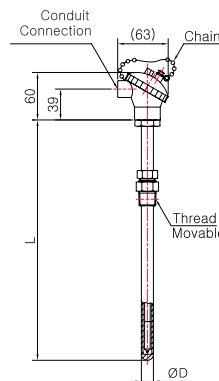

Model No. | SS-5016S-3
(Metal Protection Tube)

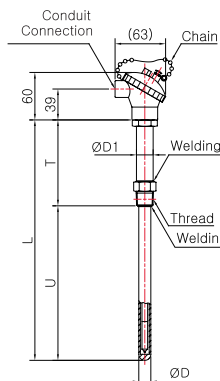

General Purpose Head Type

Model No. | SS-5017S
(Metal Protection Tube)

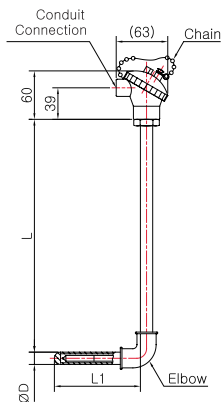

Model No. | SS-5019S
(Metal Protection Tube)

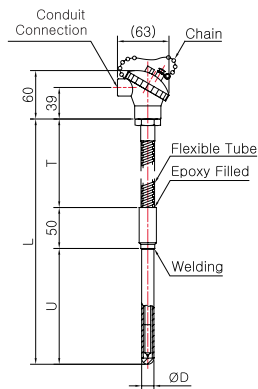

Model No. | SS-5019S-1
(Metal Protection Tube)

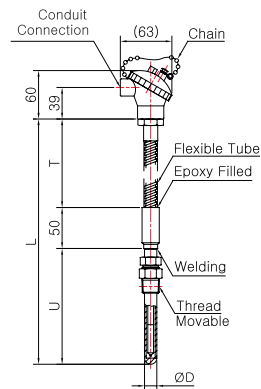

Model No. | SS-5019S-2
(Metal Protection Tube)

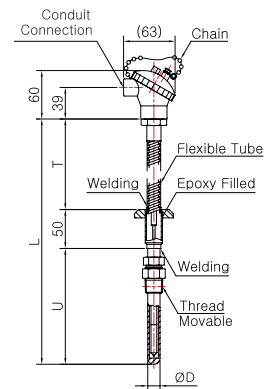

Pressure Gauge

Differential Pressure Gauge & Switch

Accessories of Pressure Gauge

Thermometer & Thermometer Switch

Thermocouple & R.T.D

Thermowell

Transmitter

Indicator etc.

Technical data